

ASSEMBLY TIPS - WORKING WITH PLASTIC FRAMES

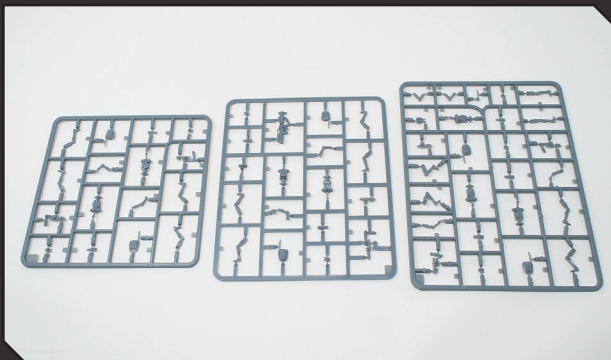

Polystyrene or hard plastic frames allow a greater level of detail and part rigidity that is often superior to softer plastics. The material also offers some advantages when it comes to assembly if you use the right tools and methods.



Three useful tools when working with plastic frames (from left to right) are flush-cut clippers, a hobby knife, and plastic glue. Plastic glue can only be used with hard plastic, like that which our frames are made out of. Super glue can be used on all types of plastic, but we recommend plastic glue when assembling miniatures on plastic frames.

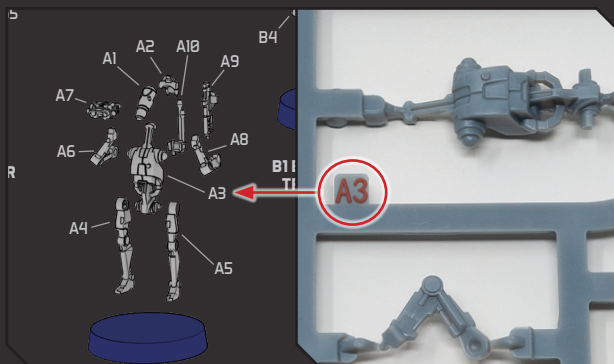

Each frame has a series of numbered small tabs that identify each part number. These are used when referencing assembly instructions included in the product or hosted online.

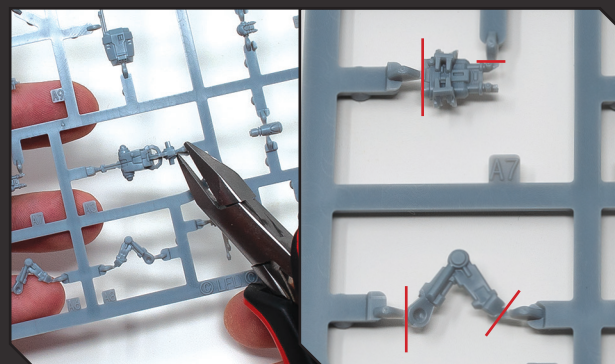

Use clippers to remove components from a frame. Place the flat side of the clippers against the component and clip them out. Each part has a tapered "gate" that narrows as it gets close to the part. Example cut lines are shown above in red.



Some prefer to only remove a single miniature's parts at a time, though it is faster to remove all the parts at once. You can use an ice-cube tray to organize each miniature's parts. We make it easy to sort each of these parts with a letter prefix before each miniature's parts. For example, Battle Droid 1 has parts A1-A10, while Battle Droid 2 is made up of parts B1-B8.



We recommend a plastic glue with a precision applicator. This glue can be found at most hobby or craft stores where they sell plastic model kits. Plastic glue is great as it does not bond to skin, takes longer to set for slight repositioning of components, and it melts the plastic together to create a stronger join. This is all very handy when working with small parts that require multiple points of contact.

ASSEMBLY TIPS - B1 BATTLE DROIDS



Start by separating out the torso and a set of legs for a B1 Battle Droid. Note many of the parts for the B1s are interchangeable, but we recommend using the designated sets of arms and legs to get the best poses for your first unit.

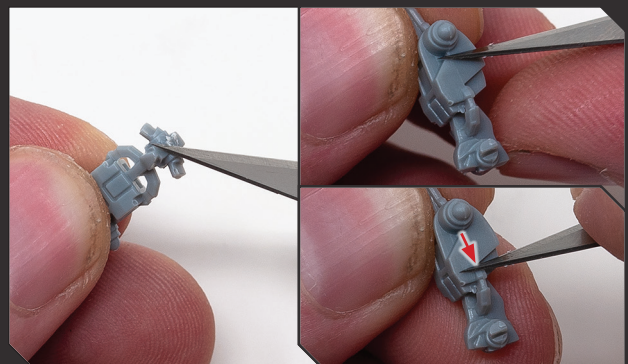

Trim any mold lines or excess material left from clipping the components from the frame with a hobby knife. When cleaning mold lines, try angling the blade away from you and scraping backwards, always being mindful of your fingers.

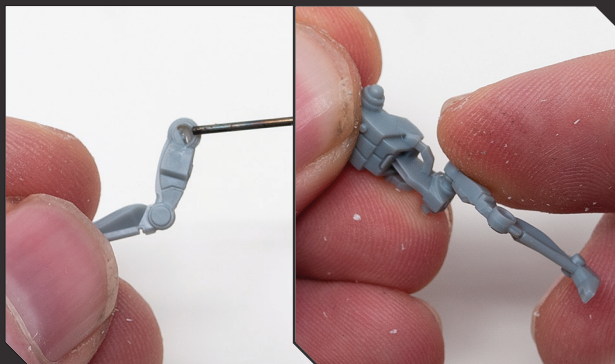

After trimming the components, put a dab of plastic glue on the indent of each leg and push the legs onto the posts on either side of the miniature's pelvis. Each peg and indent have flat sides used for alignment to get the proper leg poses.



Place a dab of glue on the bottom of each foot and glue the miniature to a base. Repeat this process for the rest of the unit. While these dry, you can move on to the cleaning and assembly of other parts of the miniatures.

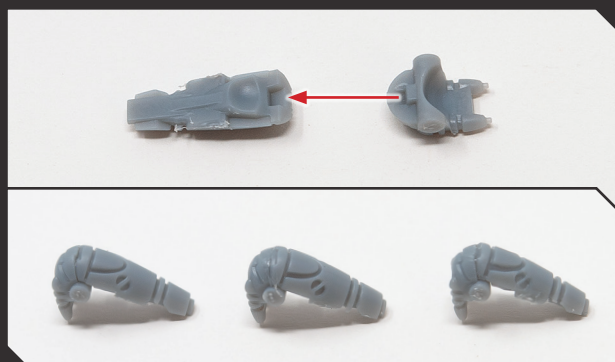

Each Battle Droid head comes in two parts. There is a small slot on one half and a square peg on the other to help with alignment. Place a dab of plastic glue on either side and press the two halves together, checking the sides for proper alignment. Repeat this process for the rest of the unit's heads, and set these aside to dry.

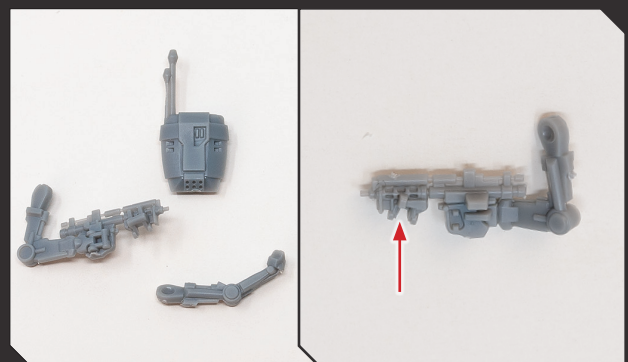

Separate out a set of arms and a backpack for a Battle Droid. Getting the three-point connection of the arms and weapon properly aligned can be a little tricky, but we have a suggestion to make the process easier. Find the left hand that is molded onto the barrel of each weapon. There are two raised wrist brackets on this hand.

ASSEMBLY TIPS - BI BATTLE DROIDS

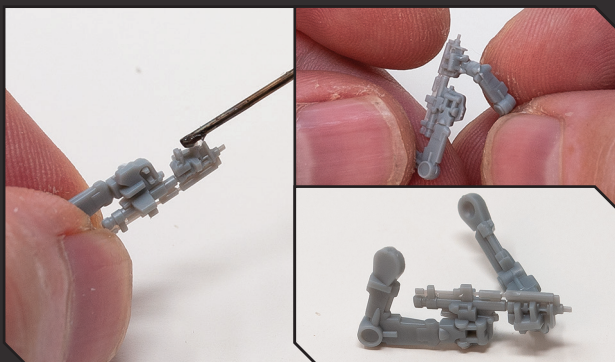

Place a dab of glue between the wrist brackets and then glue the tab on the end of the left arm to the recess. Try to align the arm so the shoulders are in line with one another. Set this aside to dry for a few minutes, but do not let it dry completely. You want to use the flexibility of the uncured glue to help align the arms to the shoulders in the next step.

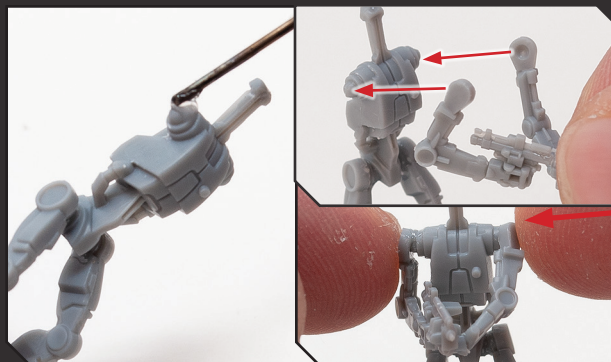

Put some glue on the round ball joints on either shoulder. Carefully pick up the two arm sub-assembly made in the previous step and push the round indents on the interior of the shoulders in contact with the ball joints on either side of the torso. Check to make sure that the glued join at the wrist is still properly connected. Set this aside to dry and repeat these steps on the next miniature.

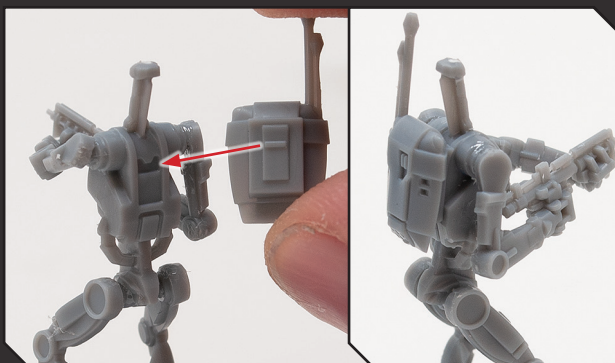

Each of the optional backpacks have a raised tab used to align the backpack to the rear of the torso. Test fit and glue the backpack in place if you prefer.



Put some glue on the interior recess of the head and glue it to the top of the neck. Gently adjust the angle of the head to get the desired pose.

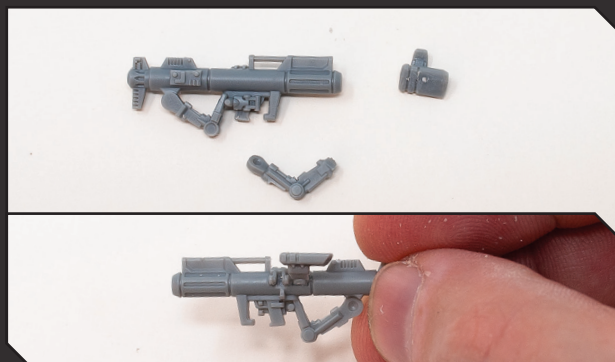

The E-60R B-1 trooper droid has a few unique parts. Begin the assembly by gluing the range finder to the square recess on the interior of the missile launcher.



Glue the head of the E-60R B-1 trooper droid to the torso. Align the head to face forward with its chin pointed down to start. Next, test fit the missile launcher to the miniature's right shoulder to ensure proper alignment with the miniature's eyes and the range finder.

ASSEMBLY TIPS - BI BATTLE DROIDS

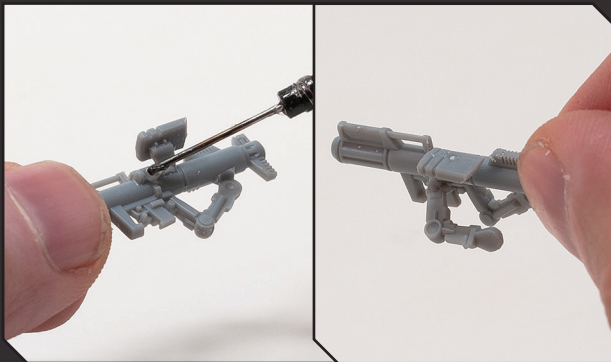

Put a dab of plastic glue on the wrist brackets of the left hand holding the missile launcher, much as you did for the standard battle droid. Glue the post on the end of the left arm to the missile launcher and set this aside dry for a few minutes.

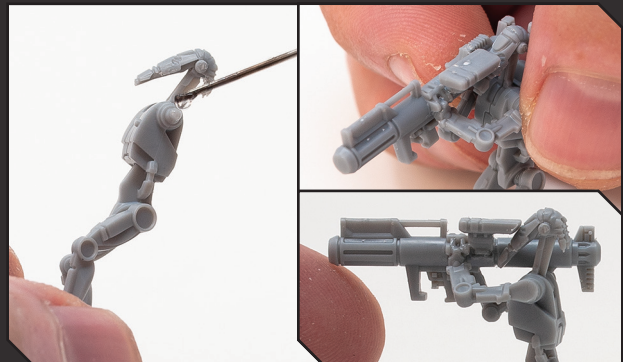

As before, put some glue on each shoulder ball-joint and slip the arms over top. Pinch the arms together to glue the arms at the shoulders. Gently adjust the angle to get the range finder to align with the miniature's eyes.



The E-5C B-1 trooper miniature has a special backpack with an indent on the right side. This is for the miniature's spare E-5 blaster rifle. Glue the tab on the left side of the weapon to the indent as shown above.



The unit leader also has some unique parts. Align and glue the binocular hands in place in a similar fashion to how you aligned the missile launcher range finder in the previous step. Again, glue the arms at the wrists first and then glue the arms to the shoulders of the miniature. Gently adjust as necessary.

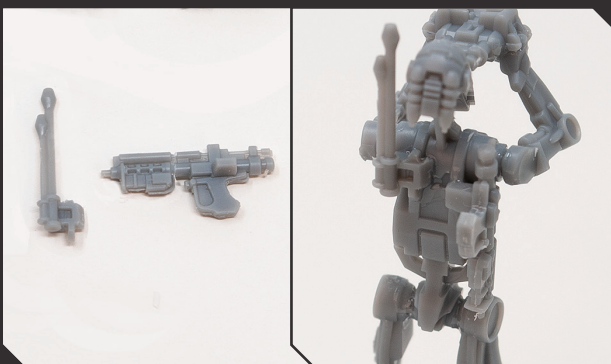

The unit leader does not have a backpack. Instead it has an antennae and E-5 blaster rifle attached to its back. Glue these pieces as indicated, using the small tabs on each part to connect to the miniature's back.



Above are the miniatures assembled in the previous steps. As mentioned before, you can interchange the parts to achieve different poses for your miniatures. You may find that it is best to keep the pairs of arms together as swapping either arm for another may create alignment issues. Test fit the parts before gluing and have fun customizing your unit!

ASSEMBLY TIPS - DROIDEKAS

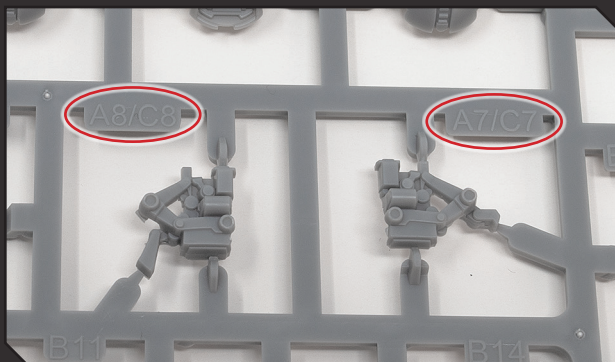

You will notice that some of the part numbers on the frames of the droider have numbers with both an "A" and "C". This is to indicate these parts are used for both poses of the droider. Parts labeled with a "B" are used for the wheel mode variants.

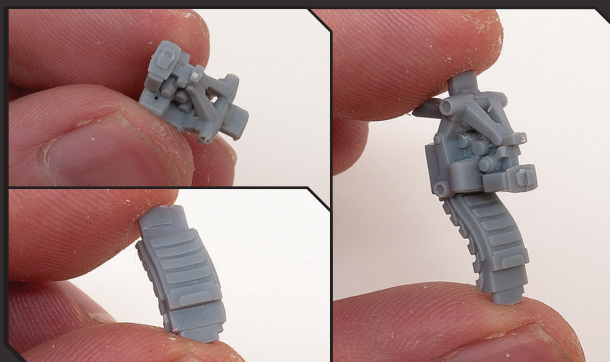

Assemble the two halves of the upper torso so the parts meet flush together. The lower torso slots into the bottom of the upper torso. Be sure to trim any excess plastic from the top and bottom of the lower torso to get a good fit.

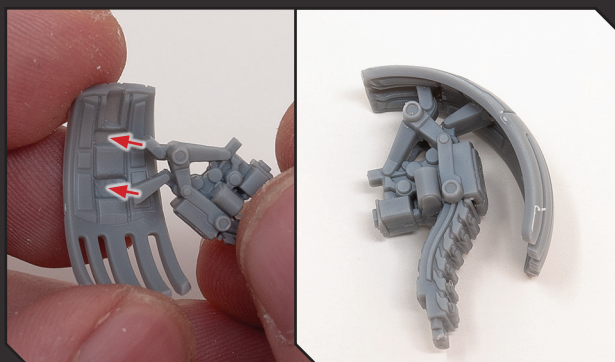

The back carapace has two rectangular indents that align with the two rectangular pegs on the rear of the upper torso. Apply some glue to the indents and affix the back carapace in place as shown.

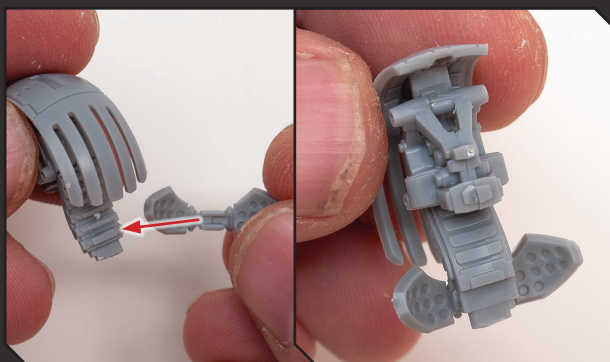

On the back of the lower torso, near the bottom, there is a raised rail of plastic that is used to attach the lower panels. Glue the channel on the lower panels to this rail.

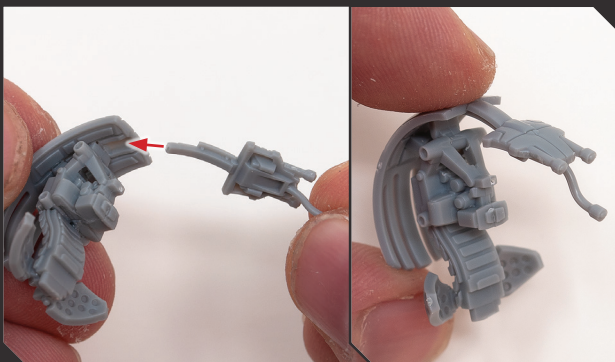

At the top of the back carapace, there is a channel on the interior of the part. This is used to glue the tab on the neck of the head in place. Place a dab of glue on the channel and affix the head in place. Adjust for proper alignment. Set this half of the assembled droider aside to dry.

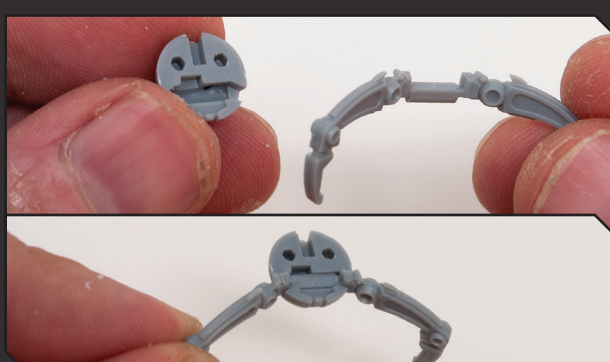

For the lower half, insert the front legs into the channel on the lower half of the lower body. The part should rest flush with the flat top of the lower body. When a proper fit is confirmed, glue the front legs in place.

ASSEMBLY TIPS - DROIDEKAS

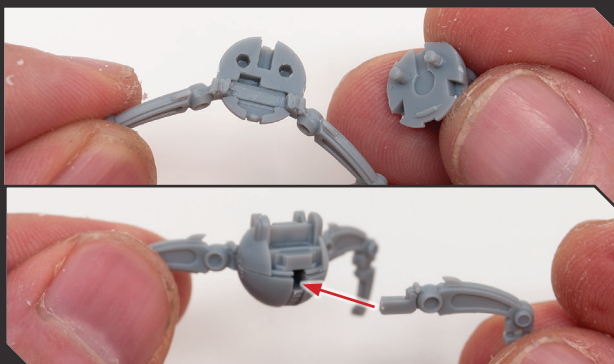

The upper half of the lower body has two pegs used for alignment with the two holes in the lower half. Glue this part in place and then glue the rear leg in the rectangular hole at the back of the lower body.

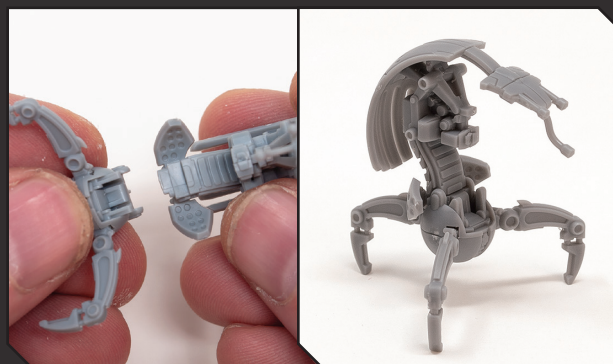

Test fit the two sub-assemblies together. They should join securely by inserting the tab at the bottom of the upper torso into the slot at the back of the lower torso. Trim the tab on the lower torso with a hobby knife to get a good fit if necessary. When the parts meet flush, glue the two halves together.

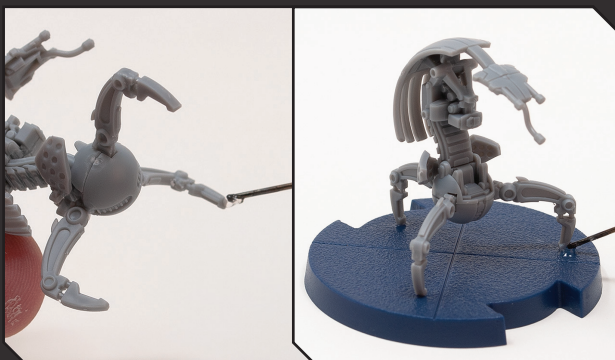

Place a dab of glue on the bottom of each foot and glue the miniature to a base. Be sure that the notches on the base are aligned with the front and rear of the miniature, not the sides. You may want to put a little dab of extra glue where the foot meets the base for a stronger join.

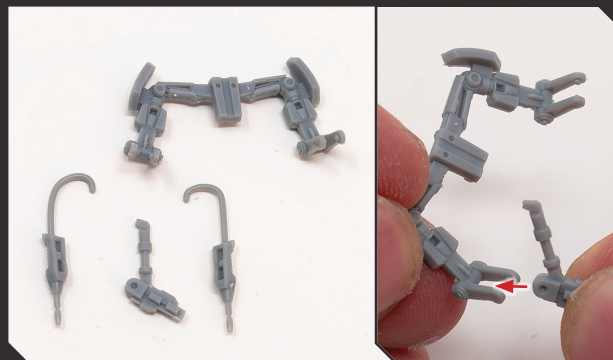

Each arm is made of a center piece and two halves of the twin blaster cannon. These parts attach to the shoulder piece. Begin by pushing the centerpiece of the arm between the two supports at the elbow of the arm. The round bumps at the elbow of the shoulder piece should fit in the recesses on either side of the center piece of the arm.

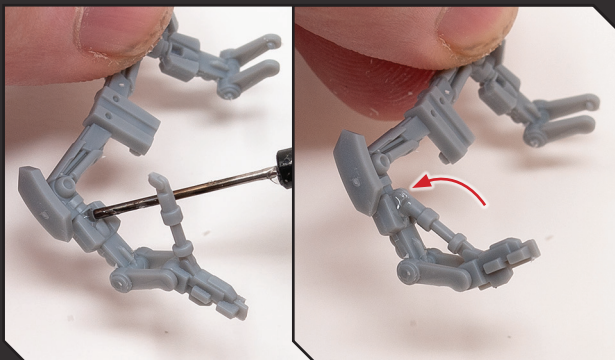

Place a dab of glue in the square hole in the arm on the shoulder piece and then rotate the center piece of the arm so the square peg at the top of the center piece fits in the hole.

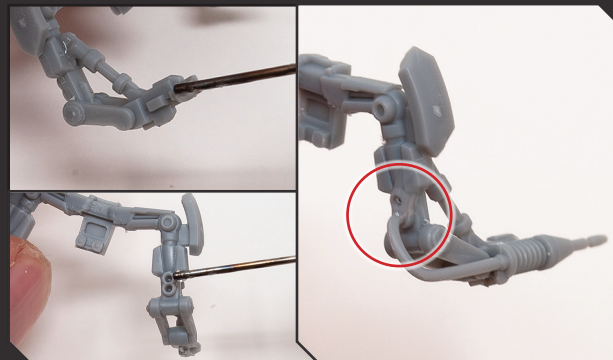

Place glue on the square tab at the front of the center piece and on the holes on the back of the shoulder piece. Glue the outer half of the twin blaster cannon to the center piece and gently align the cable so it fits into the bottom hole at the back of the shoulder piece.

ASSEMBLY TIPS - DROIDEKAS

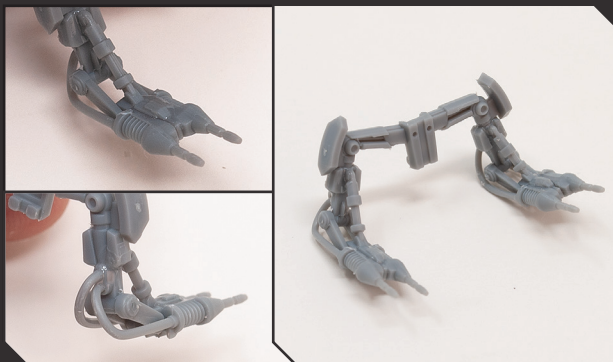

Repeat the process of the previous step for the other half of the twin blaster cannon. This time, gently align the cable so it aligns with the upper hole at the back of the shoulder piece. With the left arm complete, glue the two halves of the left arm twin blaster cannon in place in the same fashion as the right arm.



Test fit the shoulder piece to the upper torso. This part aligns with the square tab in the center of the upper torso. Place a dab of glue on the recess on the inside of the shoulder piece and push it into place. That completes the assembly of the standard droideka. Assembly of the wheel mode variant is very similar and should be handled with the same methods.

ASSEMBLY TIPS - GENERAL GRIEVOUS



General Grievous has several options for his construction. See the assembly diagrams in the Learn to Play for a rundown of the parts needed for each configuration.



All versions of Grievous share the same torso and legs. Clip these parts from the frames. The torso has two halves with a hexagonal hole and peg for proper alignment. When removing the legs and feet, try to keep the left foot (D6) with the left leg (D4) to get the proper angle of the legs and feet.



Glue the torso halves together and then glue the feet to the legs and the legs to the torso. After gluing the legs in place, gently adjust them while holding the miniature against the work surface so the feet lay flat.



Place a dab on the bottom of each foot and glue the feet to the base. Adjust the alignment slightly so the feet are flat on the base and the miniature is properly centered.

ASSEMBLY TIPS - GENERAL GRIEVOUS

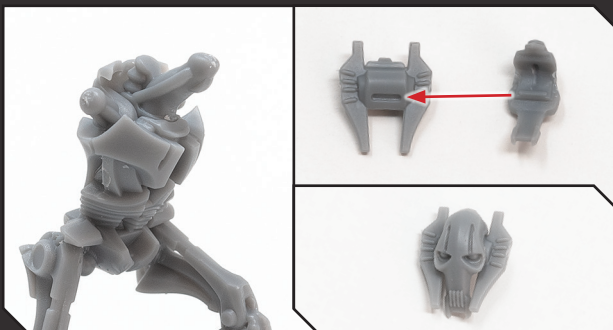

Glue the neck piece to the oval-shaped recess at the top of the torso. Be sure that the neck leans forward toward the front of the miniature. Glue the two halves of the head by aligning the rail on the interior of the face plate with the recess on the interior of the back of the head. Don't glue the head down yet if you want to assemble Grievous with the cloak.



General Grievous has a number of arm options. These examples show his non-split arm options. Mix and match the arms together to achieve your desired pose.

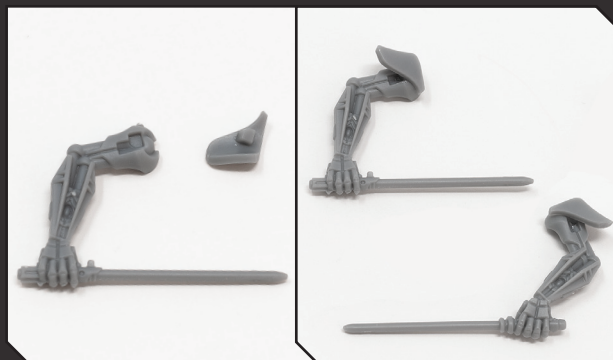

There is a square hole at the top of each arm. This is for attaching the shoulder pads. The narrow point of the shoulder pad should point forward. These same shoulder pads are also be used for the split arms assembly in the next step.



Grievous' split arms come in two parts. At the rear of the lower arm on each side, there is a ball joint for attaching the second half of each arm. These arms also have a square hole for attaching the shoulder pads, though you should leave these shoulder pads off if using the split arms with the cloak.

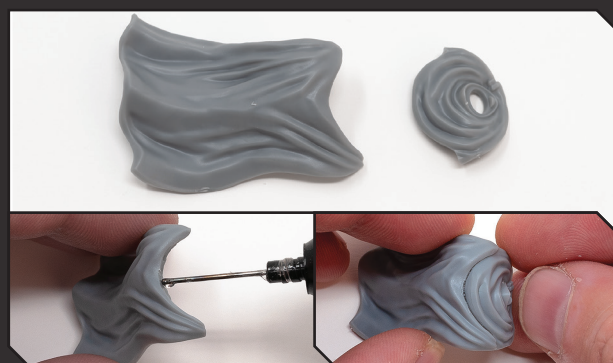

Grievous' cloak comes in two parts. Test fit the two halves together before gluing. Trim any excess material from the frame for a good fit. Apply plastic glue to the joining face of one part and press the two parts together. Be sure that the edges and folds line up together well. Let the cape dry for 5-10 minutes before proceeding to the next step.

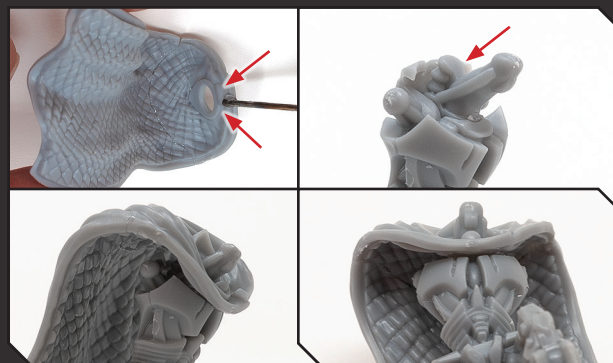

To affix the cloak, apply glue to the underside of the front of collar and to the flat surface on the back of the neck. Slip the cloak over the neck and press it down on to the torso. Make sure that the cloak meets the top of the chest plate and rests on the back of the miniature securely.

ASSEMBLY TIPS - GENERAL GRIEVOUS



Place glue on the rounded recess of each arm. Slide each arm under the cloak and onto the shoulder ball joint. Push the cloak down and adjust the arms to get a good fit. You will find the cloak restricts the arm positioning, but the plastic glue will allow you to experiment with the posing while it dries.



Apply glue to the recess in the underside of the head. Glue it to the ball joint on the top of the neck. Adjust the angle of the head to get the desired pose.



These are just a few of the myriad of options available depending on what components you choose and how you pose them.

ASSEMBLY TIPS - BARC SPEEDER



Unlike the Separatist miniatures, the Republic BARC speeder is not supplied on a frame. The parts above are used for the BARC speeder. Separate these parts out and confirm that you have everything. Contact Customer Service if anything is missing.

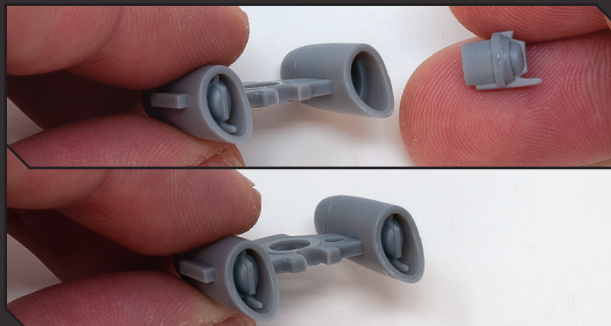

Begin assembly by gluing the turbines into the engine housing. The rail that runs along the bottom of each engine insert aligns with a channel at the bottom of the hole in the engine housing.

ASSEMBLY TIPS - BARC SPEEDER

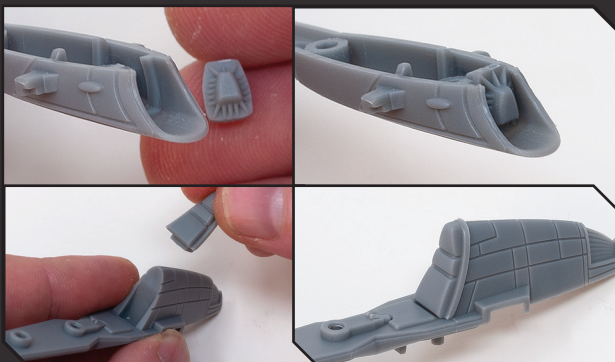

Glue the turbine in at the front of the lower half of the BARC speeder and glue the seat in place. Press the parts against the guides to make sure the parts sit flush. You may need to trim excess frame material off of the parts for a good fit.

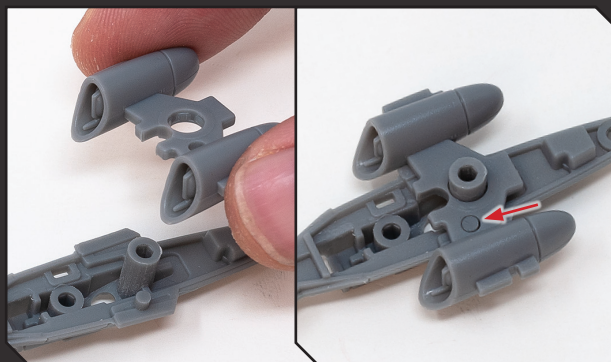

Glue the engines to the lower half of the BARC Speeder. Use the secondary peg and hole for proper alignment. Make sure that the part sits flat against the lower half.

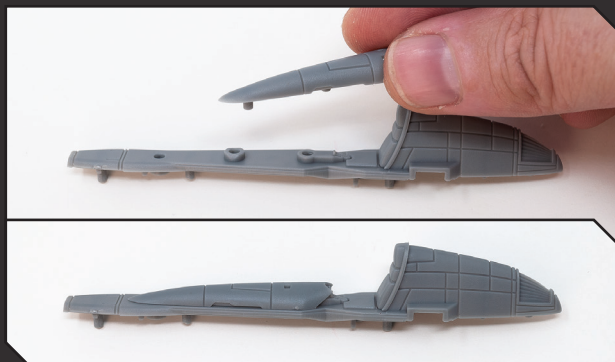

Glue the top cover to the upper half of the BARC Speeder. Lightly apply glue to the pegs and around the rim of the top cover. Wipe away any excess glue that comes out of the sides when you press the parts together with a paper towel.

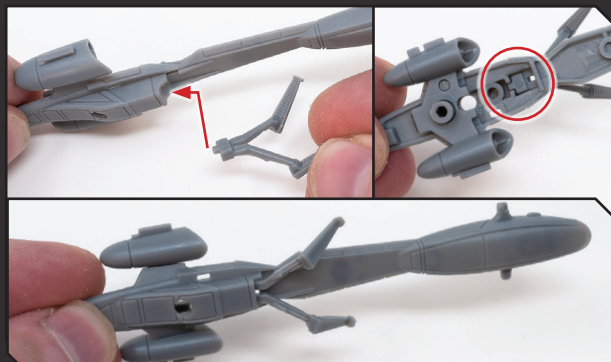

Glue the foot pedals in place by placing a dab of glue on the tab where the two pedals come together. Insert the tab into the hole on the bottom half of the BARC Speeder. Make sure the tab rests flat in the groove inside the hole.

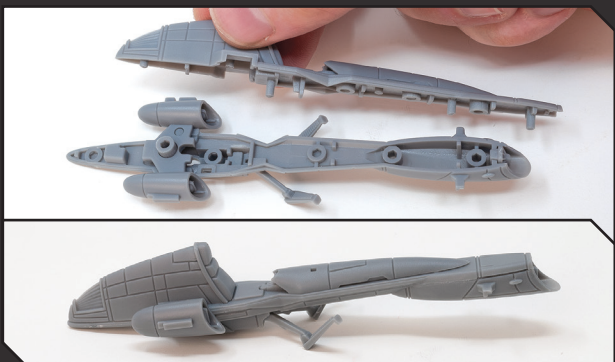

Glue the upper half of the BARC Speeder to the lower half. As before, lightly apply glue to the pegs and around the rim of the lower half. Wipe away any excess glue that comes out of the sides with a paper towel when you press the parts together. You may want to use rubber bands to hold the two halves together while the glue dries.

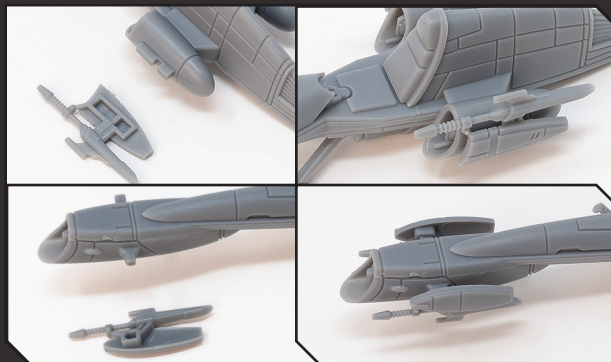

Glue the side panels on either side of the rear of the BARC Speeder. The rear panels have unique tabs and slots on either side to ensure they are matched up correctly. For the front panels, glue them in place so the weapons are on the lower side. Adjust the panels slightly so they are parallel with the central axis of the BARC Speeder's hull.

ASSEMBLY TIPS - BARC SPEEDER

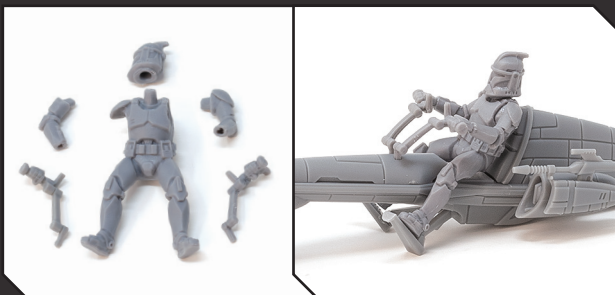

Use super glue to assemble the driver. After building the driver, put a dab of super glue on each foot and on the bottom of each handlebar. Insert the handlebars into the two slots on the top cover of the BARC speeder and then press the driver into the seat so his feet touch the pedals. Hold until the glue cures.



These are the parts used to assemble the optional sidecar. As these parts are made of hard plastic like the rest of the vehicle, you may use plastic glue to assemble these parts.

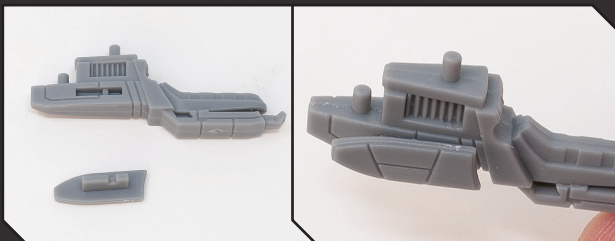

Assemble the two halves of the sidecar base and glue the outer cover to the right side of the sidecar base.

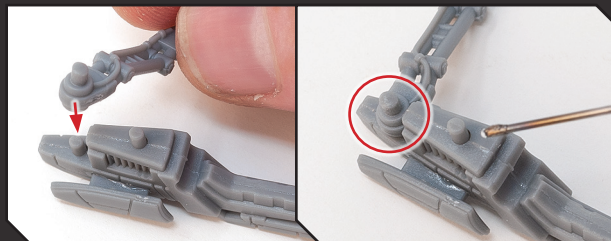

Place the sidecar rear hinge over the post at the back of the sidecar base. Place some glue on the top of the sidecar base near the second post, but be careful to not get any glue near the hinge if you want the sidecar to be able to swivel later.

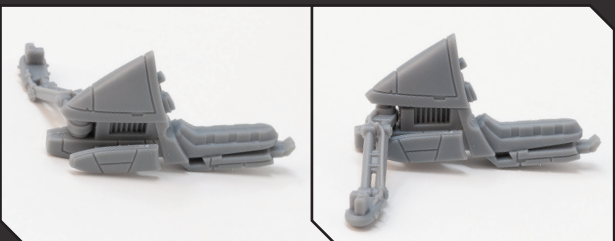

Glue the rear cover to the top of the sidecar base, over top of the sidecar rear hinge. Test the movement of the hinge to make sure it moves properly.

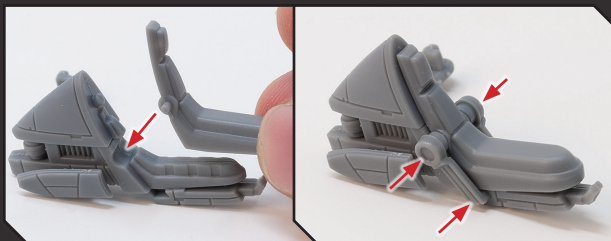

Glue the sidecar seat in place and then glue the seat supports on either side of the seat, aligning the support so it goes over the post on the side of the seat and the bottom tab goes into the slot at the bottom of the seat.

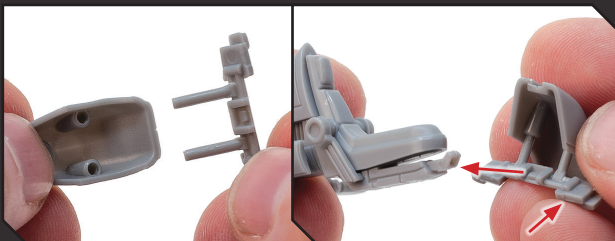

Glue the foot pedals to the bottom of the front of the sidecar. The pedals should angle diagonally downward toward the back of the sidecar to allow the gunner's feet to fit properly.



When gluing the sidecar front to the sidecar base, place the gunner's legs in the seat to make sure that the angle of the sidecar front puts the pedals in contact with the feet.

ASSEMBLY TIPS - BARC SPEEDER

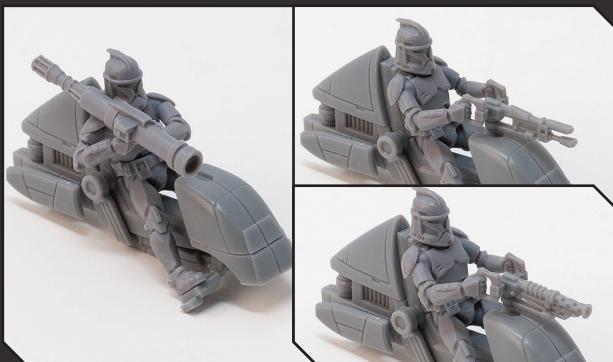

The gunner can be assembled with one of three different weapons options. As with the driver, you must use super glue to assemble this part of the miniature.

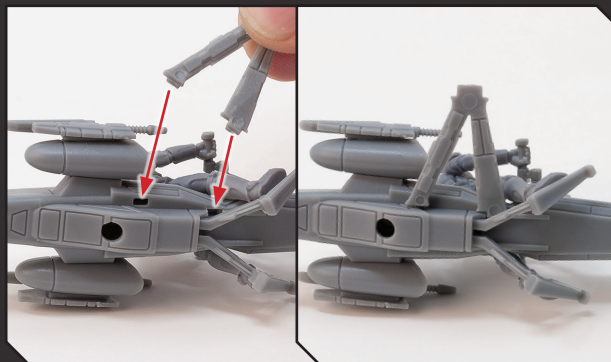

Glue the tabs on either end of the v-shaped support to the two holes on the bottom of the BARC Speeder.

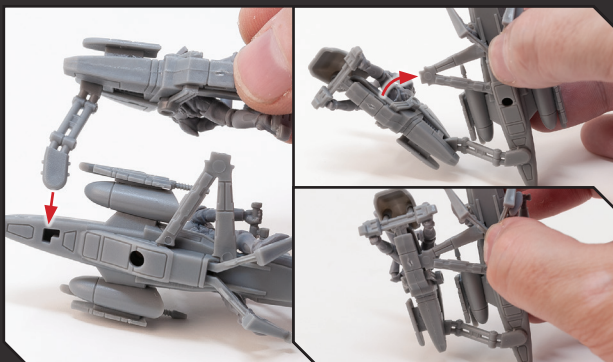

Glue the L-shaped peg at the end of sidecar rear hinge to the similarly shaped hole at the rear of the BARC Speeder lower half. Test the hinge to make sure that the slot in the sidecar base aligns with the tab on the v-shaped support.

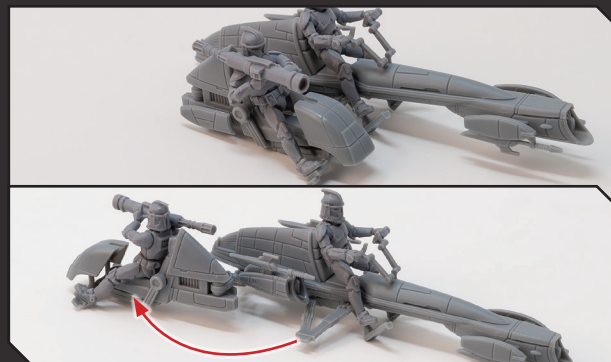

This image shows how the sidecar swivels. Simply glue the tab on the v-shaped support to the slot on the sidecar base if you do not want your BARC Speeder to swivel.

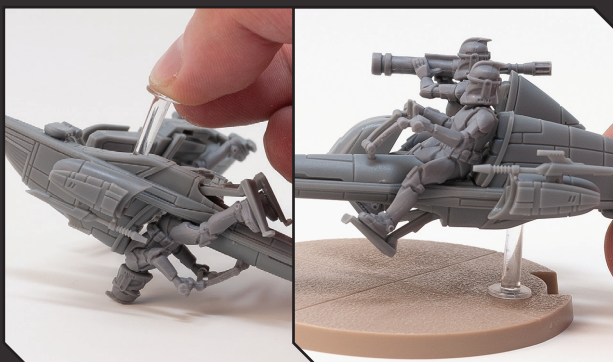

Flip the BARC Speeder upside down and insert the clear peg into the hole on the bottom of the vehicle. Twist the peg until it sinks deeper into the hole and feels snug. Test fit the BARC Speeder with attached peg over the base until you get the placement you like and make note of the position.

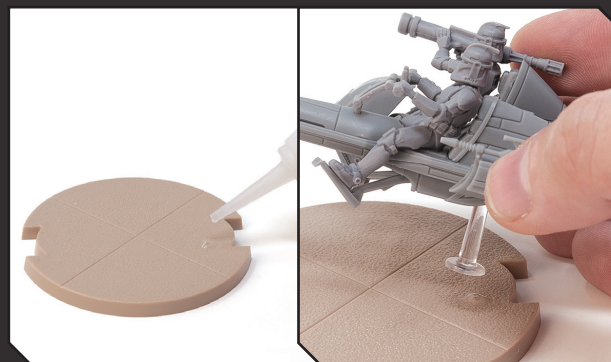

Before attaching the BARC Speeder peg to the base, make sure your desired placement aligns the front and rear of the BARC Speeder with the notches on the front and rear of the base. Attaching the clear peg requires super glue. Place a dab on the base and hold the miniature in place until the glue cures. This concludes assembly of the hard plastic miniatures in the core set. We hope this guide proves useful getting your forces ready for the tabletop!